

**Puddle Flanges** are mainly used on suspended floors; either timber or concrete, to provide a good connection between the pipe work and the membrane that is laid beneath tiles in wet areas. When there is just a pipe cast into concrete it is much more effective to use our range of MEGA wastes which have an o-ring and fit flush to the floor.

The way Puddle Flanges work is to provide the bracing to the connection while the recess acts to provide controlled leakage of the mortar bed that the tiles are laid on. It should be recognized that the tiles and mortar bed alone will not be waterproof and a membrane will need to be laid to avoid expensive damage to the building structure.

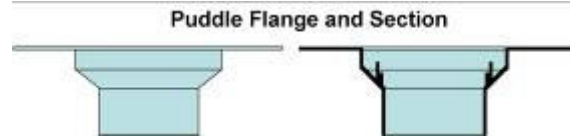

## Fitting of Flanges Generally

Ideally the flanges should be recessed a minimum of 3mm into the floor so that it is at the lowest point. This can be achieved with a router in a timber floor or a diamond grinder for a slab, however in practice; this is often regarded as unnecessary.

The flange should be affixed to the floor with SikaFlex 11fc after ensuring the surfaces are clean and free of dust and grease, the remaining SikaFlex 11fc can be used to detail the corners and to stop up any areas that are going to cause excess build-up of membrane as this would cause retarded cure of the membrane.

## Method 1: Membrane Under Bed Method

Apply the membrane, follow the manufacturers' instructions and, in particular, avoid bumps on the wall, as they will affect the tiling. The floor and 30mm up is not as critical as it gets covered with the mortar bed that gives the fall to the tiles. Dress the membrane down into the recessed area of the puddle flange providing a vertical seal.

Allow complete cure of the membrane, which, even with a fan circulating the air directly onto the area, could take 12 hours or more.

Now it is time to fit the waste grate into the flange, the grate tube can be cut down if you require a thinner bed, however it is generally accepted that a minimum bed thickness of 35mm (plus the tile thickness) is needed to provide the integrity to the bed. If using chicken wire for reinforcing, don't let sharp wire damage the soft membrane.

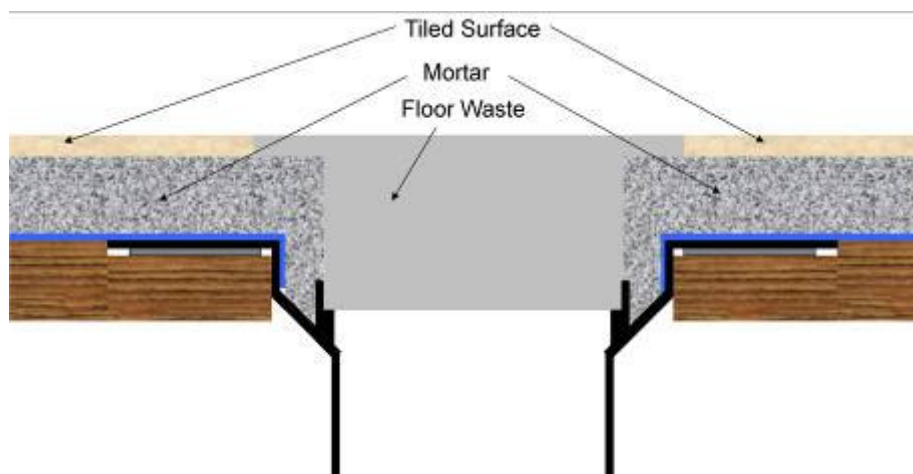
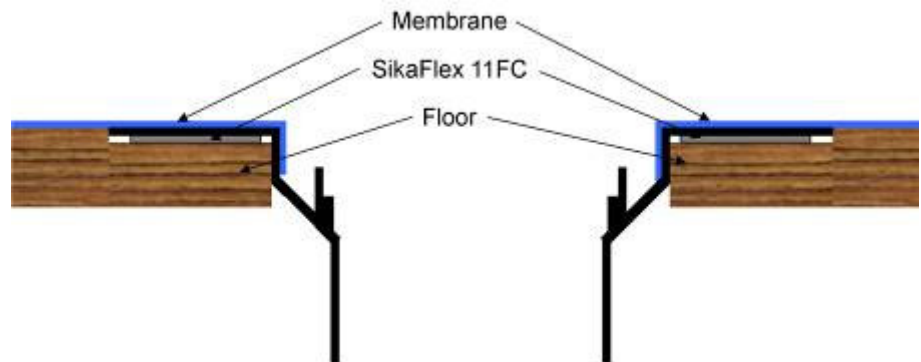

## Method 2: Membrane Over Bed Method

Some people create the falls with a mortar bed before using a membrane, in this instance the connection still needs to be made onto the flange and down the recess of the puddle flange. Always follow the manufactures instructions. The way to achieve this is to scoop out the area just around the recess so that once the mortar is fully cured the membrane is taken across and down to connect into the flange (remember the flange should be clean). Once the membrane is fully cured, the scooped out area will need to be filled in so that the tiles in the area around the waste are supported, do this with some mortar.

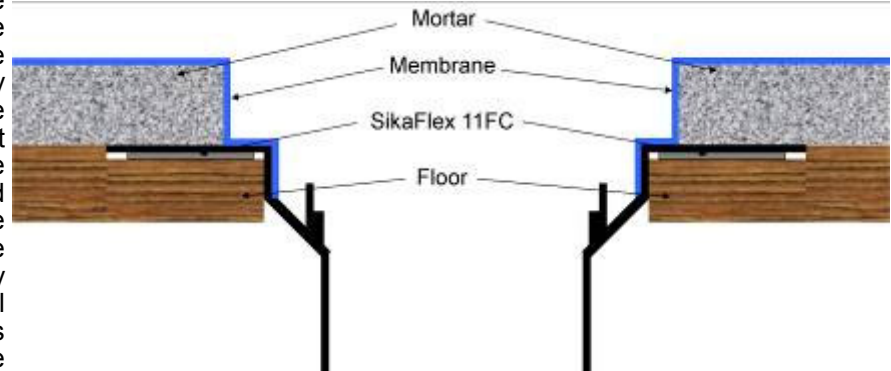

Should you choose this method, remember that the wall floor junction will have to be a sharp corner, where the tiles meet, and all the fall you require will need to be in the mortar bed before the membrane is applied.

Connection to the plumbing system is through solvent cementing of the out let to pipe

The 50mm Puddle Flange has a 50mm socket outlet which fits over pipe. The 80mm and 100mm Puddle Flanges have spigots which glue into pipe. The 100mm Puddle Flange includes a patented height adjusting connector which incorporates an Undercap that prevents mortar from falling into the pipe work.

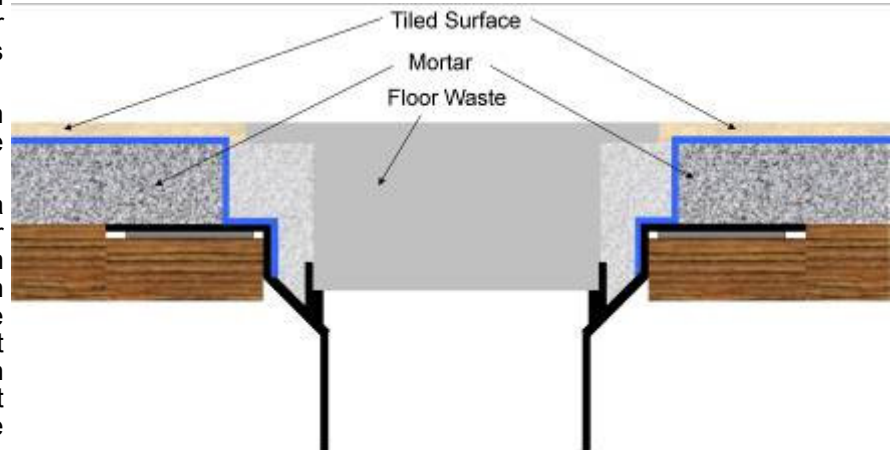

**Make sure the undercap is removed and discarded prior to using the shower.**

**The ARTPLASTICS range of plumbing products addresses specific industry requirements from Water Proofing through to cost effective Architectural Down Pipe solutions. Take a look at our range of: Floor Wastes, Plug and Wastes, General Plumbing Products, Leak Control Solutions, Down Pipes, and Clips.**



Our range of Floor Wastes includes the superior Bounty range as well as traditional plastic floor wastes through to chrome on plastic, stainless steel faced and brass waste systems.



Art Plastics have been manufacturing Plug & Wastes for local and overseas markets for over 15 years. We have the industry leading range of Plug & Wastes. Spare parts are available for all Plug & Wastes. This includes 32mm, 40mm, 50mm and 90mm sealing washers, grates, backnuts and plugs.



Art Plastics has a diverse range of specialized and high value added general plumbing products. Our range includes Flanges, Gutter Drops, DT Grates, Slab Repair Adapters, Test and Tile Cap and Plugs, Rainwater Heads, Snap In Vents, Elbows and Sud Saver Rinse By-Pass Kits.



Art Plastics has the industry leading range of leak control products. Our in-house expertise ensures we remain at the forefront of the industry with developments such as our new Mastics Support Flange and associated tooling representing a total solution.

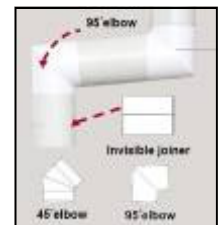

Art Plastics is pleased to announce the release of our new Classic Downpipe System comprising UPVC fittings that make the installation of architectural down pipes quick and easy! Simply use standard 90mm pipe to create a seamless look.

QLD - Collis Marketing (07) 3805 6664  
 NSW/ACT - Wasteland (02) 9674 7680  
 TAS - Wholesale Products (03) 6273 3455

VIC - Midlink (03) 99879 4080  
 WA - Pride Industries (08) 9272 6511  
 SA - RD Agencies (08) 8387 7344